

# XLOCK Handle

---

## Mounting Guide



**X LOCK**  
Unlock your imagination.

# Guide



PACKAGING  
(PAGE 4)



OVERVIEW  
(PAGE 5)

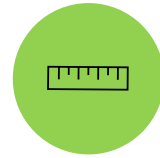

MEASUREMENTS  
(PAGE 6)



TECHNICAL  
SPECIFICATIONS  
(PAGE 7)



DOOR OPENING  
(PAGE 8)

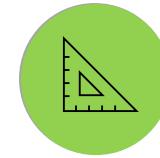

ADD PIN CODES  
(PAGE 9)



DOOR FITTING  
(PAGE 10-11)



MOUNTING  
PREPARATIONS  
(PAGE 12-14)



MOUNTING ON  
DOOR  
(PAGE 15-16)



BATTERIES  
(PAGE 17-18)



XLOCK APP  
(PAGE 19)



TESTING  
(PAGE 20)



FURTHER FUNCTIONS  
(PAGE 21-22)



# Packaging

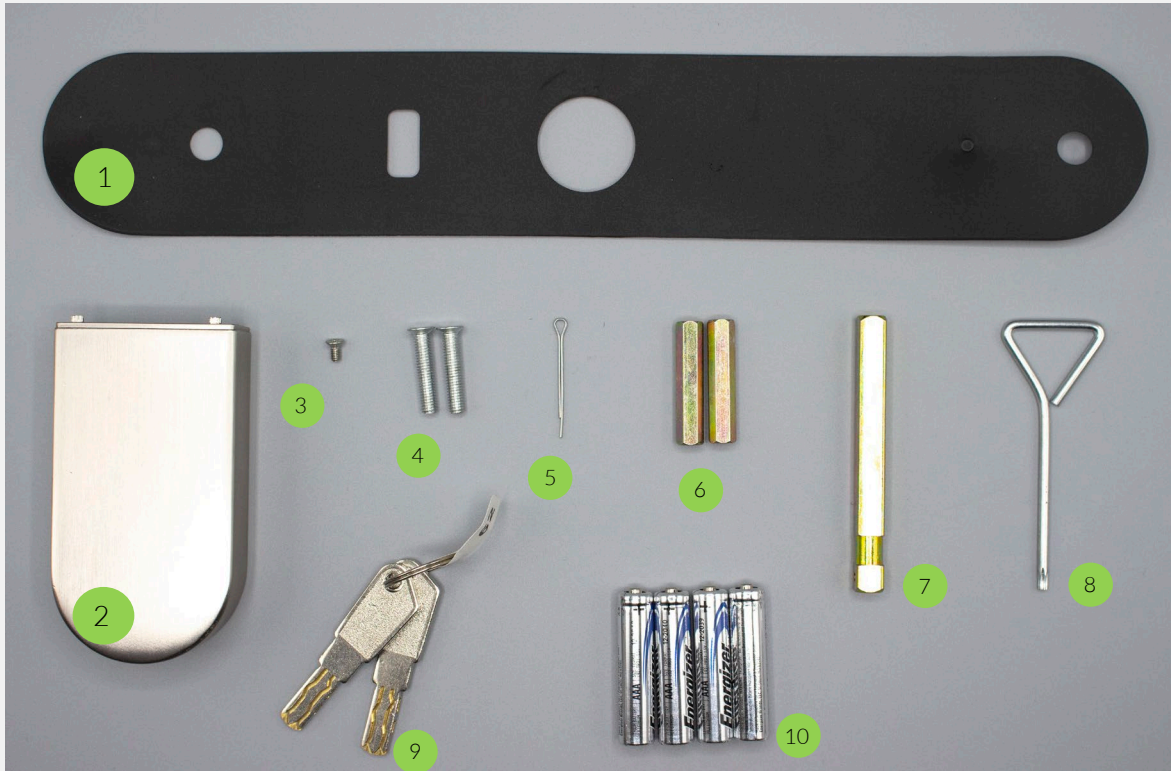

1)	Rubber mat
2)	Battery cover
3)	Screw for the battery cover
4)	Fixing screw
5)	Split pin
6)	Threaded sleeves for fitting



7)	Pusher Pin 79 x 8 x 8 mm
8)	Screwdriver for batterie cover
9)	2 pcs emergency keys
10)	4 x AAA-Lithium batteries (Please do not use Alkali batteries!)
11)	Exterior door handle
12)	Interior door handle



# Overview

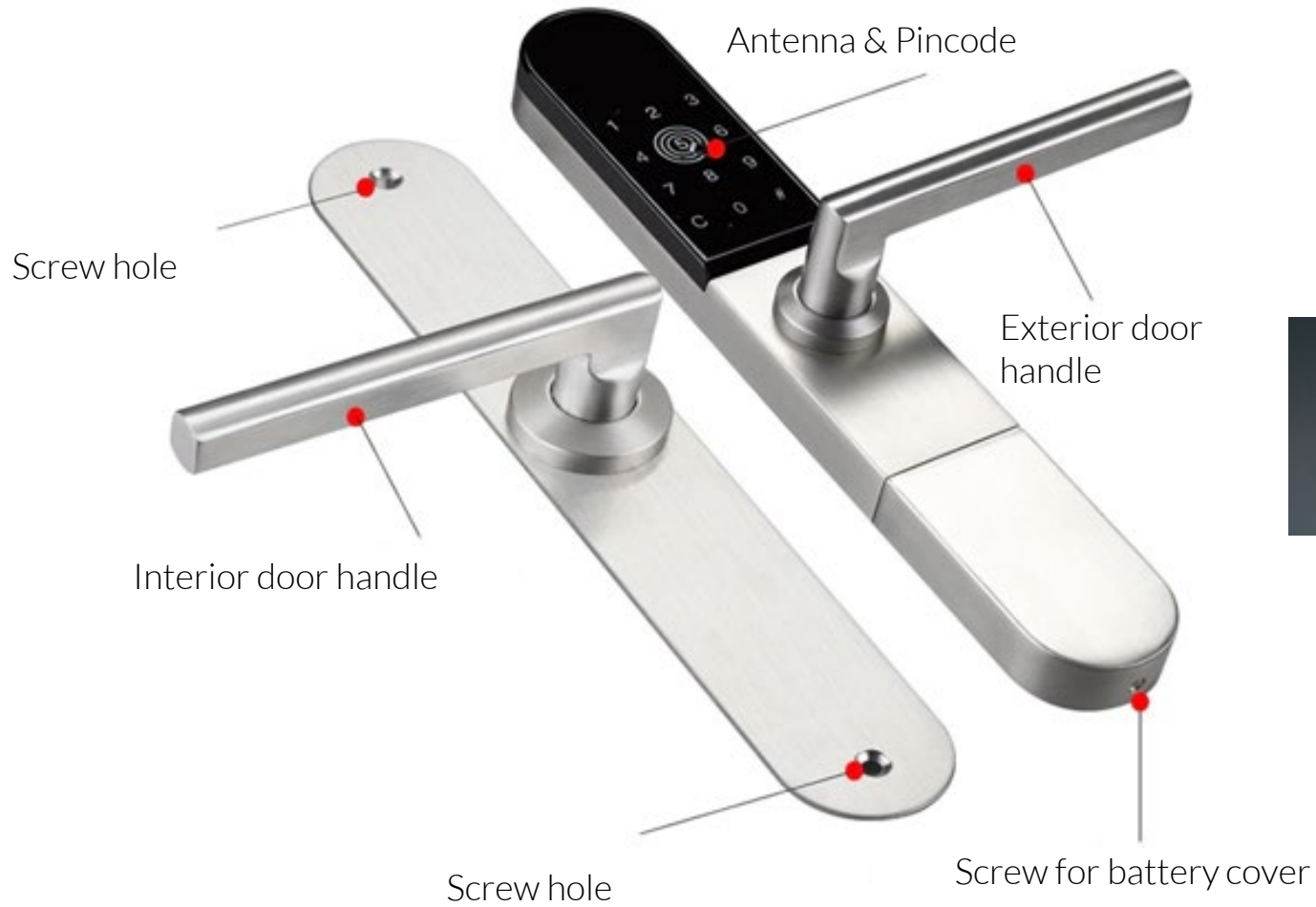

Biometrics



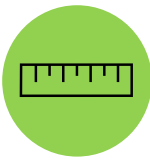

# Measurements

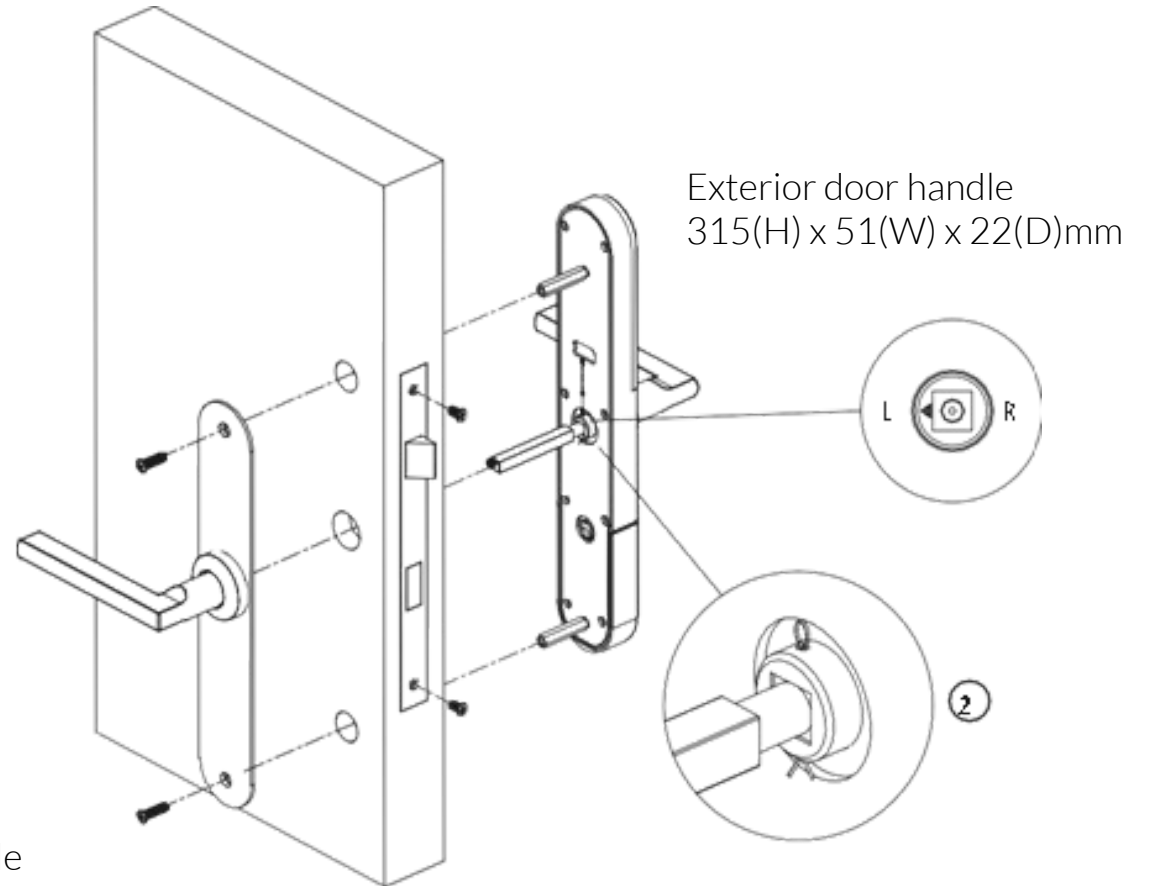

Interior door handle  
285(H) x 48(W) x 2(D)mm



# Technical specifications

Measurements	Door handle OUTSIDE: 315(H) x 51(W) x 22(D) mm Door handle INSIDE: 285(H) x 48(W) x 2 (D) mm
Weight	3 kg
Temperature	-15°C to +60°C
Humidity	20% to 75% relative humidity, non-condensing
Compatible with	RFID ISO14443a, Mifare, Pincode, XLOCK App, Gateway, Biometrics, mechanical key
IP-Code	IP52
Batteries	Exclusively use batteries provided by XLOCK. (4 x Energizer Lithium AAA = 6V DC))
Battery lifespan	Bluetooth: up to 20.000 openings (+2 years) before the battery needs to be changed
Number of users	BLE/NFC Tag/Pincode/Fingerprint: up to 200 users
Reading distance	<ul style="list-style-type: none"><li>• Up to 25 mm with cards and key fobs provided by XLOCK, Cards and key fobs from third parties have to be checked before installation</li><li>• Up to 15 metres with Bluetooth Low Energy</li></ul>
Material	Door handle OUTSIDE: Zinc Alloy, ABS plastic in the antenna area Door handle INSIDE: Steel / Stainless steel
Colours	Black anodized aluminum Aluminum silver anodized
Door thickness	38 – 50 mm, Special mounting accessories are available for longer door thicknesses



# Opening direction of the door

Exterior view

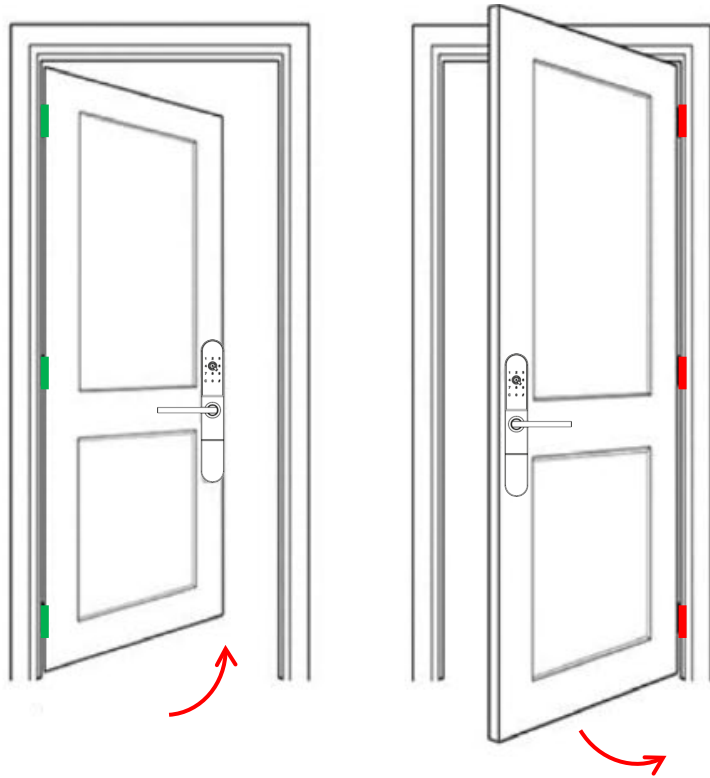

① **DIN Right**  
inwards opening  
hinge side inside

Exterior view

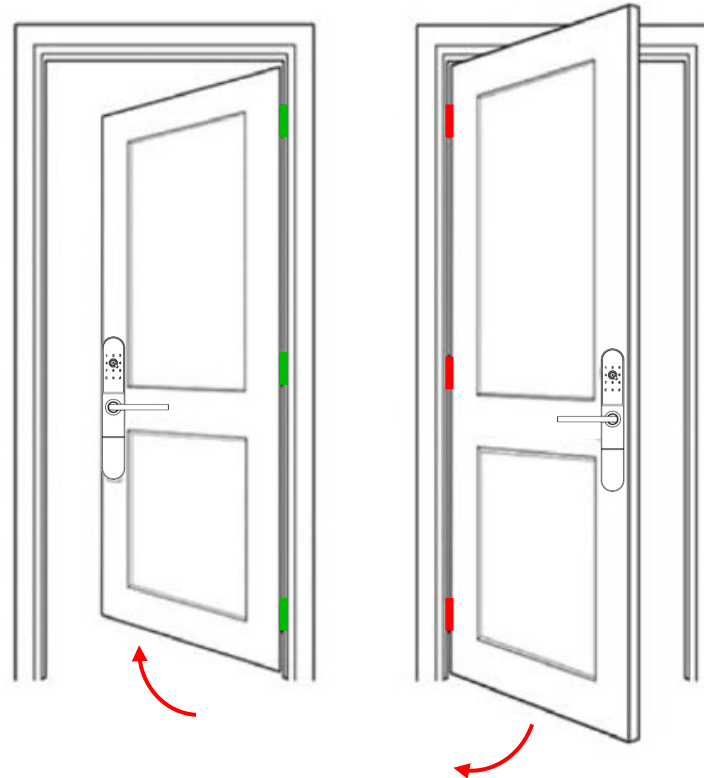

② **DIN Right**  
outwards opening  
hinge side outside

③ **DIN Left**  
inwards opening  
hinge side inside

④ **DIN Left**  
outwards opening  
hinge side outside

To define the correct type of door, please stand on the hinge side (hinge side) of the door. Then compare with the 4 illustrations. The door handle will then be prepared accordingly - see from page 9.



# Mounting measurements

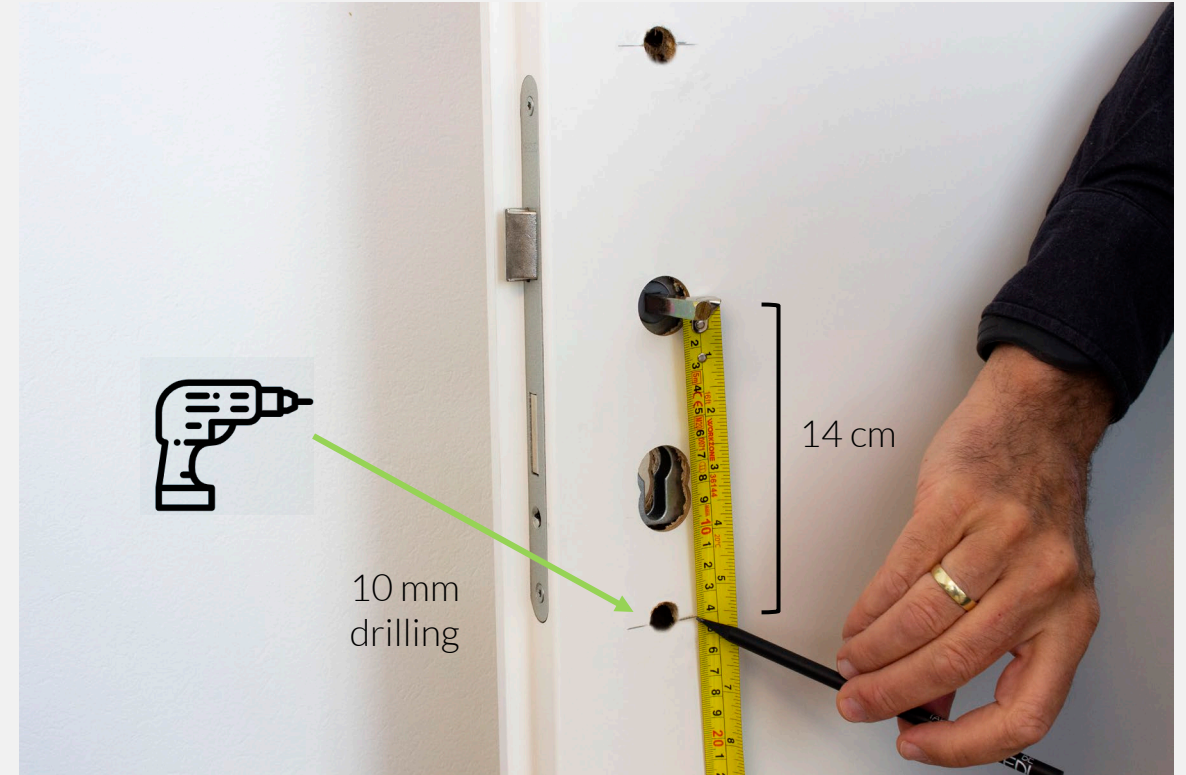
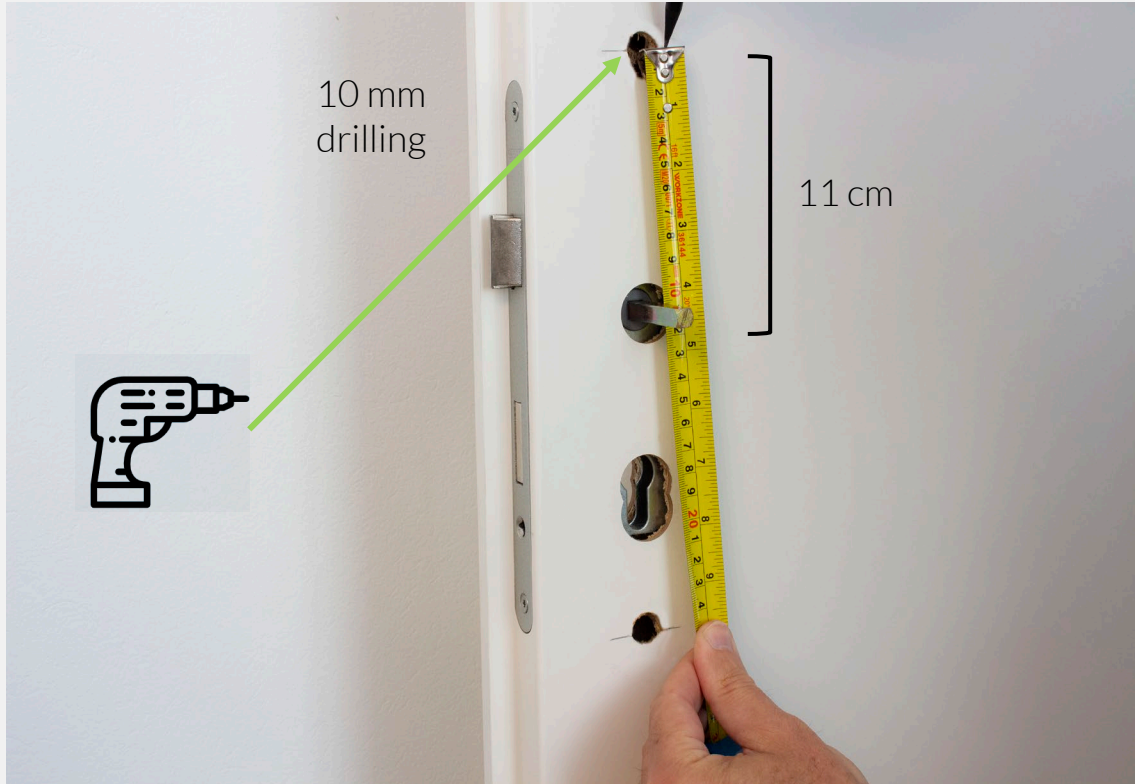

Measure the holes with the correct distance and carefully drill from both sides (the rubber pad (1) can also be used as a template). The distance from the center of the handle to the upper hole is 11 cm and to the lower hole 14 cm. We recommend pre-drilling with a 5 mm wood drill and then re-drilling with a 10 mm wood drill. Please use metal drill bits for metal doors.





## Changing the exterior handle direction



1. With an hex key (size 4), the door handle can be removed from the exterior fitting and the handle direction can be changed - door direction see page 7.

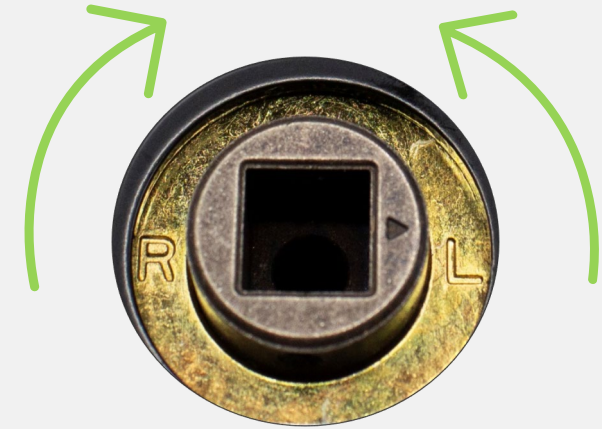

2. The opening direction of the external fitting is set by turning the square handle into the direction of the handle - for door direction see page 7.



## Changing the interior handle direction

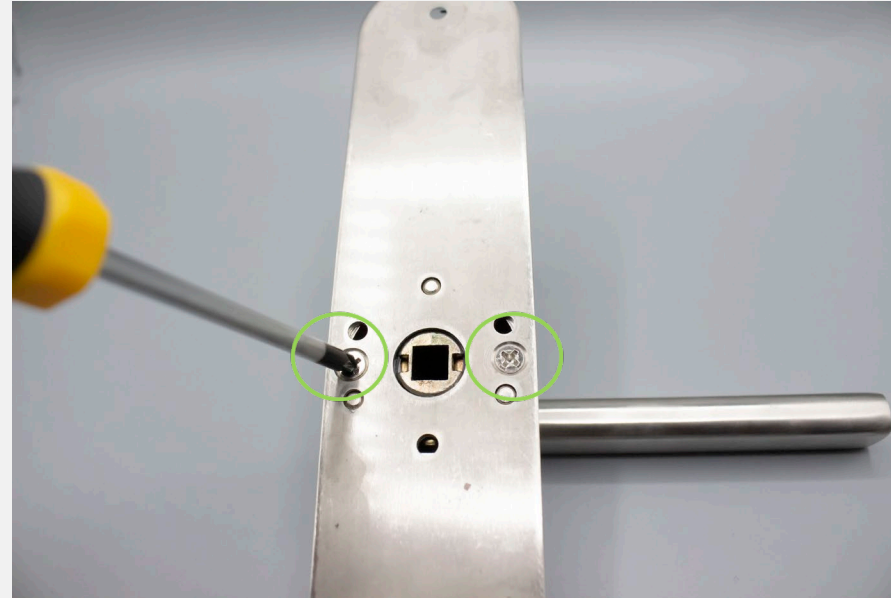

Loosen the two screws on the back and change the direction of the handle. Then tighten the two threaded screws again - see page 7 for door direction.



# Mounting preparations



1) Carefully screw the two threaded sleeves (6) onto the two threaded rods on the back of the outer fitting.

2) Then fix the handle pin (7) in the outer fitting.





## Mounting preparations



Secure the trigger pin (7) with the split (5) by bending the split pin ends upwards.



## Mounting preparations

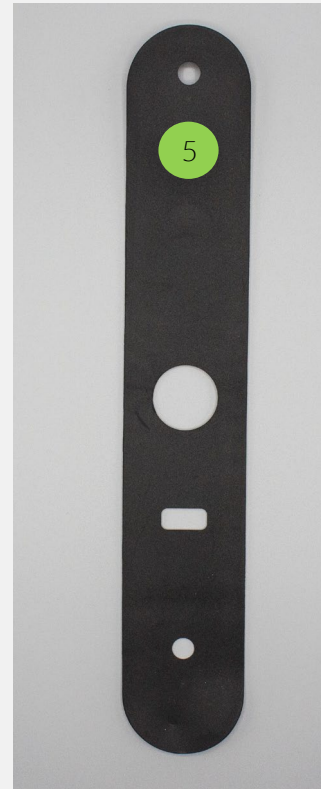

Place the rubber mat (5) on the back of the outer fitting.



## Mounting



Slide the outer fitting evenly on the outside of the door.



## Mounting



Hold the outer fitting and carefully screw the inner fitting onto the back of the door with the other hand.



# Batteries

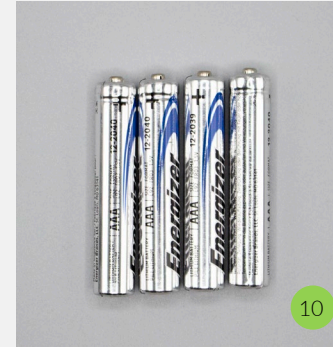
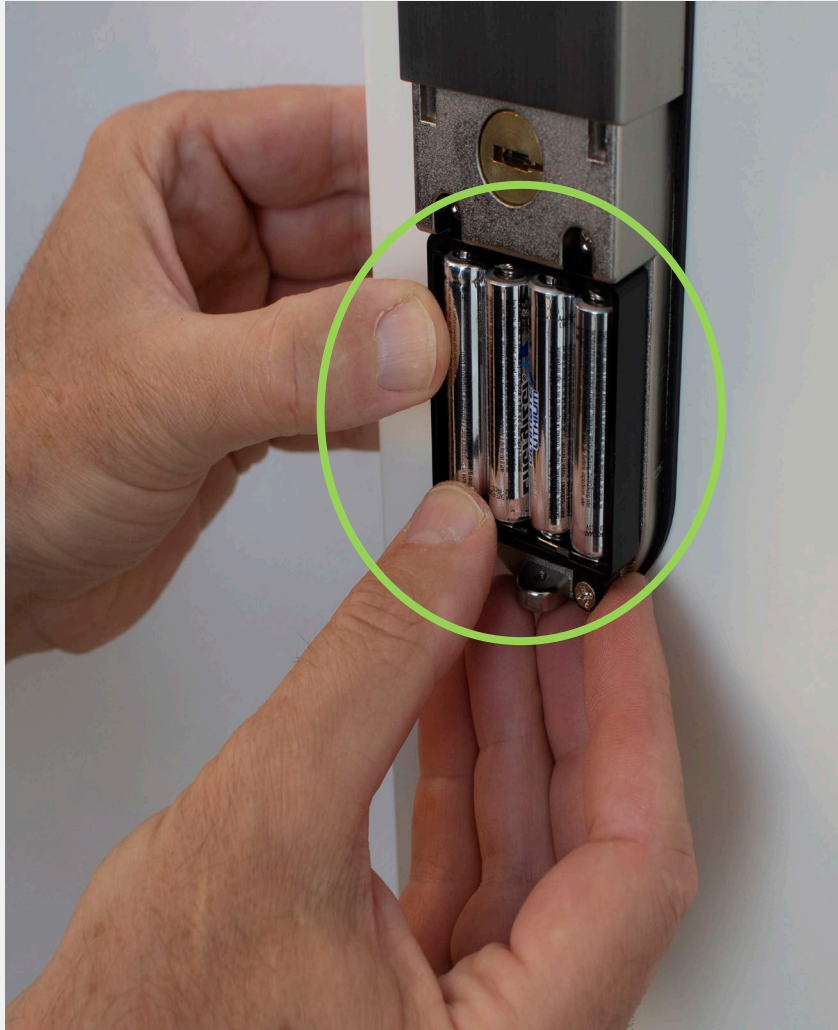

Insert 4 pieces AAA-Lithium Energizer batteries (4) = system is active.

**Important:**

Do not use alkaline batteries!

When changing the batteries, always replace all 4 batteries with new batteries at the same time.





## Mounting of battery cover



Carefully fix the battery cover with the correct screw (3) and the supplied screwdriver (8).



## Set up XLOCK App



- 1) Download the XLOCK App on your smartphone or tablet.
- 2) Awaken the door handle by carefully touching the pin code field.
- 3) Add the door handle in the APP with the account.

READY FOR USE!

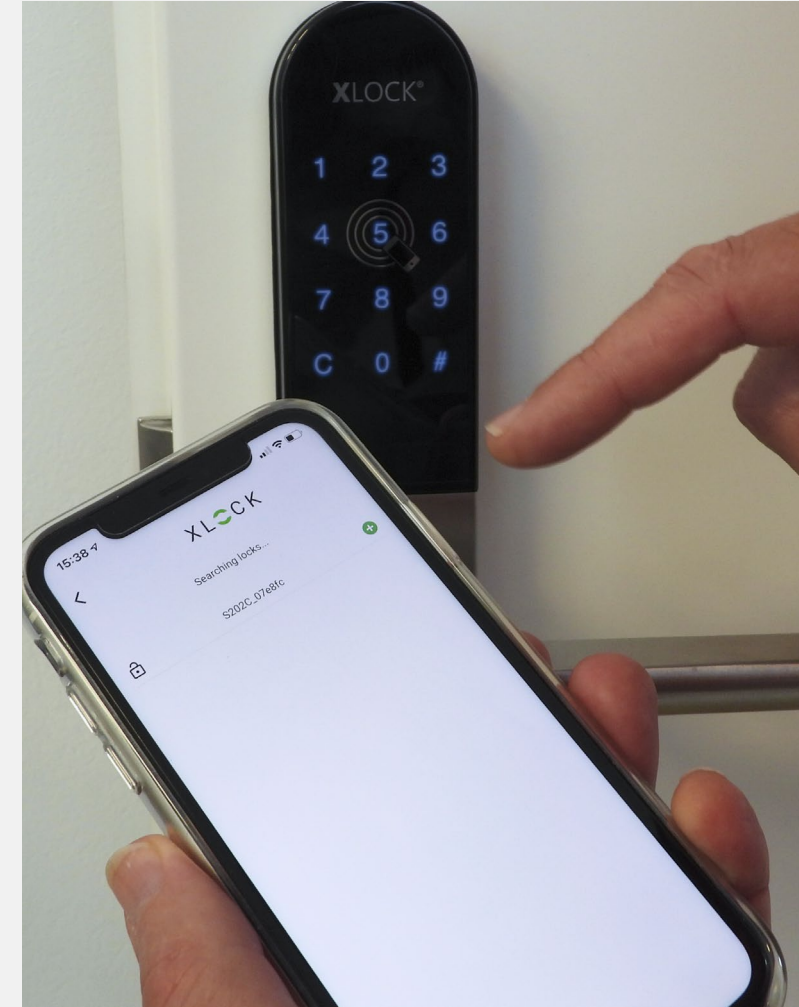



## Testing



Finally, check all functions on the door handle. It is important that the external fitting is easy to move and that it is decoupled when it is locked (idle). The inside fitting must always open the door reliably = emergency reasons.

**Attention:** If the outside handle is not idling, please change the opening direction - see page 9.



## Further functions – mechanical unlocking

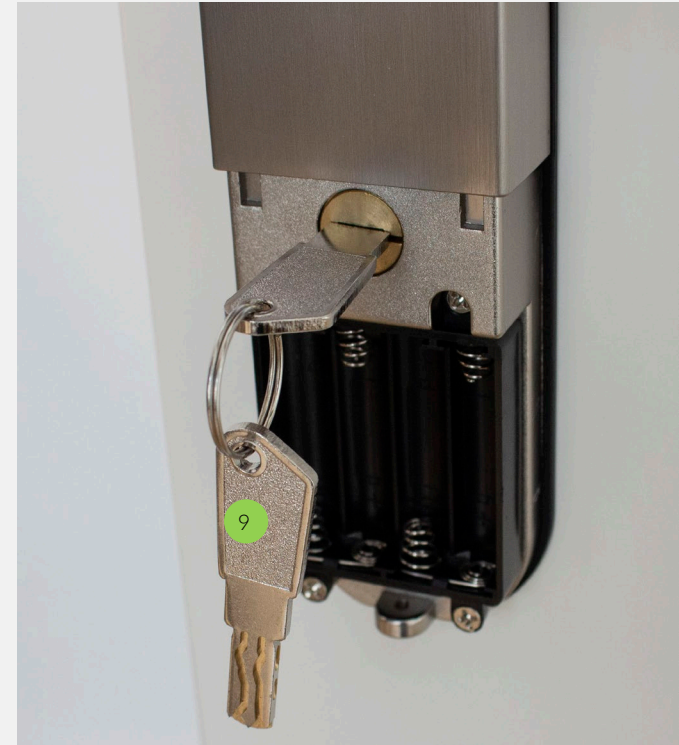
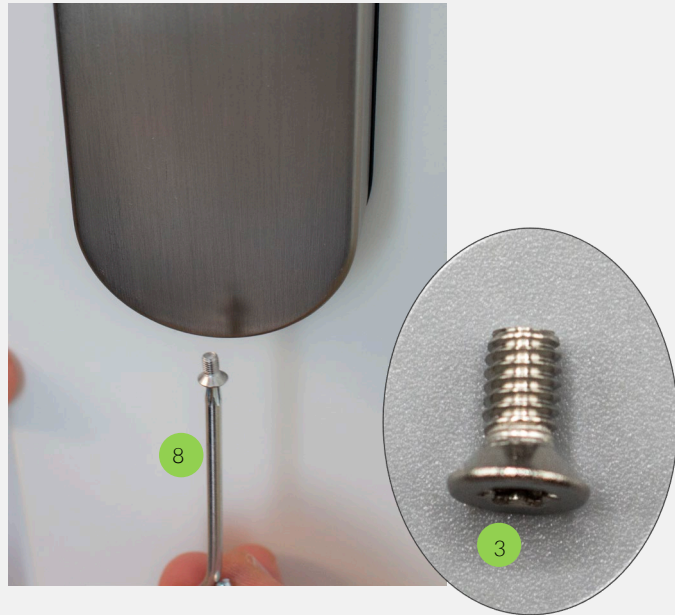

In an emergency, the door fitting unlocked manually.

Unscrew the battery cover screw (3) with the supplied screwdriver (8). Remove the battery cover (2). Then deactivate the lock by carefully turning the emergency key (9). The door is unlocked as usual by pressing the door handle.



## Further functions – Handle locking

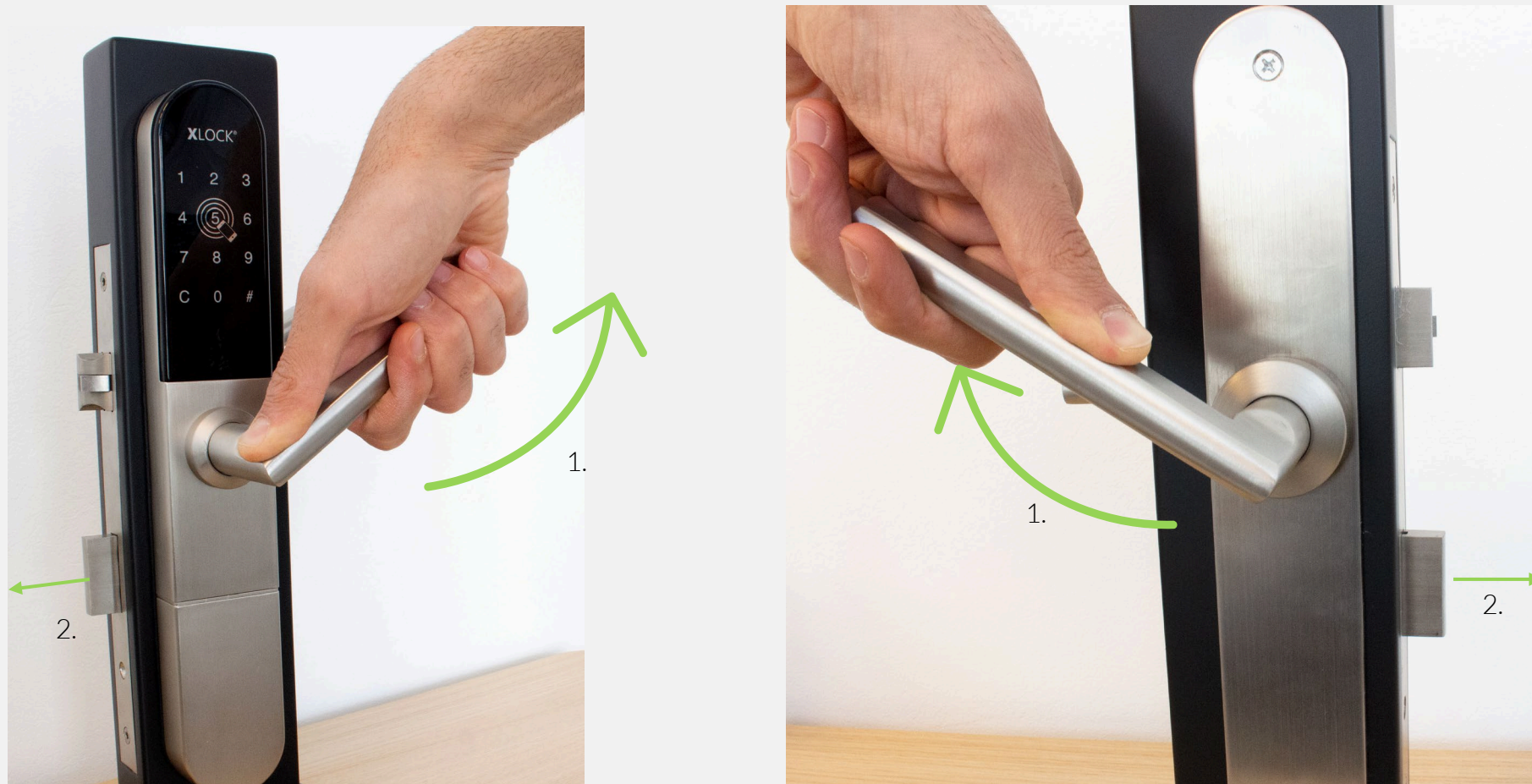

There are special mortise locks, in which the bolt is locked by lifting the door handle, see illustration. By operating the door handle, the bolt and the latch are withdrawn and the door is unlocked. Our door fittings support this safe and practical locking method. Alternatively, self-locking panic locks can also be used.



## Further functions – reset button



If a door handle was already connected to an XLOCK account and was not deleted via the XLOCK app, the reset button on the back of the outer fitting must be pressed for approx. 3 seconds. A double tone confirms that all settings have been reset.

**Recommendation:**

If the door handle is installed and you wish to change the administrator simply transfer the lock to another account via the XLOCK app.

For more information, please read our XLOCK app guide.



LET'S  
UNLOCK  
THE  
FUTURE  
TOGETHER!

info@xlockgroup.com  
www.xlockgroup.com