



# // XLOCK Smartbox

- your smart keybox.



1. Choose a place to mount your XLOCK Smartbox.



2. Drill four holes with the help of the rubber mat.

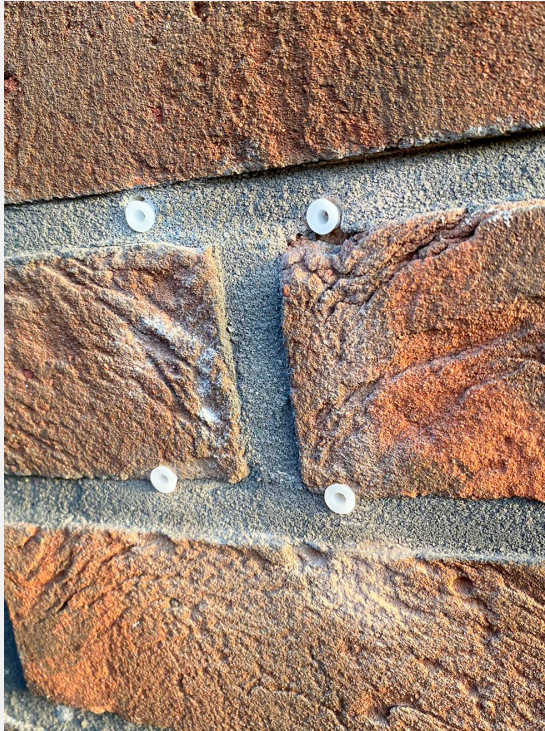

3. Insert the dowels in the holes.

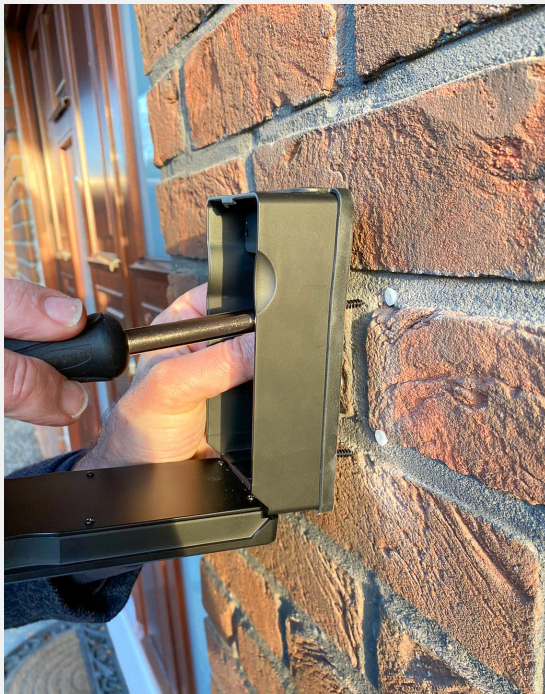

4. Insert the screws with the help of a screwdriver.  
(Remember the rubber mat for protection)



5. Close the Smartbox.

- it is ready for use!

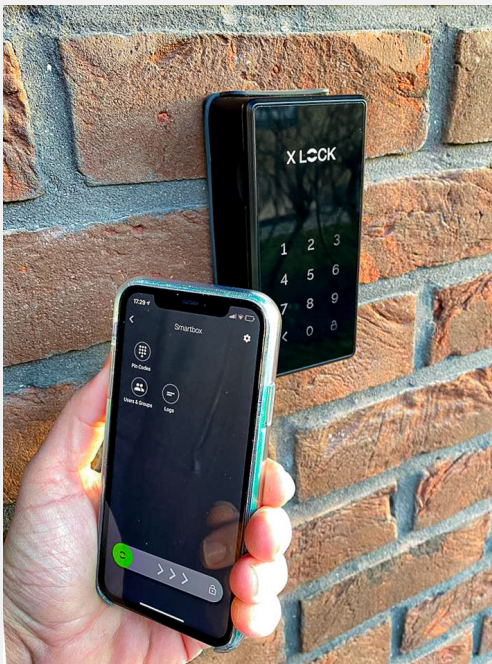

Smartphone unlocking



PIN Code unlocking

## DOORKNOB & EMERGENCY OPENING

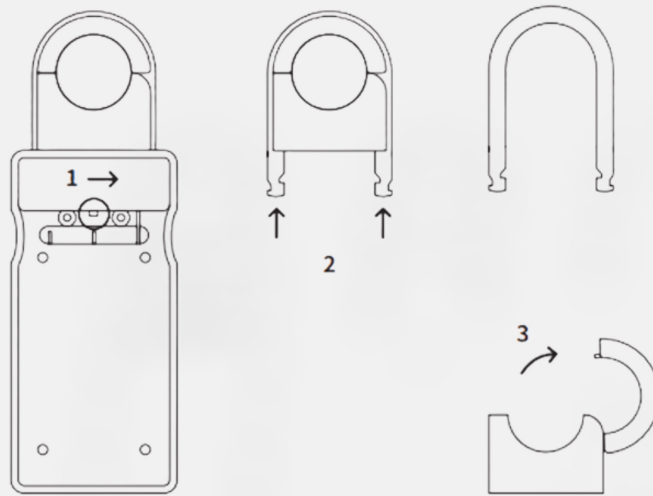

1. Open the XLOCK Smartbox and, as shown in the picture, push the button inside to the right.
2. Remove the buckle.
3. Open the buckle and hang it on the doorknob.
4. Close the buckle and reattach it to the XLOCK Smartbox.



### ! PLEASE NOTE !

THE BATTERY FOR EMERGENCY OPENING IS NOT INCLUDED.

Hold a 9V battery on the two pins at the bottom of the XLOCK Smartbox. Then open the XLOCK Smartbox via Pincode or Bluetooth and change the 4 lithium AAA batteries.

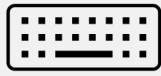

Temporary & Permanent PIN Codes



Concealed Battery Compartment



Bluetooth Unlocking



Activity logs to see who accessed at what time



Gateway unlocking from anywhere in the world



Emergency Jumpstart



Unique PIN Code Technology



Masking PIN Code



Management by XLOCK App (iOs, Android)



UNLOCKING POSSIBILITIES.

X LOCK

[info@xlockgroup.com](mailto:info@xlockgroup.com)  
[www.xlockgroup.com](http://www.xlockgroup.com)